

SOLID RIVETS

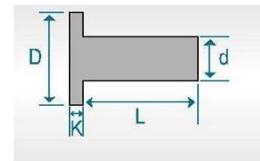
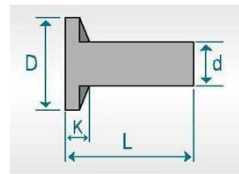
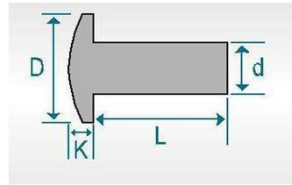

d +0,00 -0,10 diameter	L +0,30 -0,00 length	D +0,20 -0,20 round head	D +0,20 -0,20 countersunk head				D +0,20 -0,20 flat head			
---	---------------------------------------	---	---	--	--	--	--	--	--	--

		UNI 748	UNI 749	UNI 750	UNI 751	UNI 752	UNI 753	UNI 754	UNI 755	UNI 756
2	3 ÷ 100	3,5	4	4,6	5,2	4	6	4	4,8	3,5
3	4 ÷ 100	5,3	6	7	7	6	8,4	6	6,5	5,3
4	6 ÷ 100	7,1	8	9,2	8,8	8	11,2	8	8,2	7,1
5	6 ÷ 100	8,8	10	11,5	10,5	10	14	10	9,9	8,8
6	6 ÷ 100	10,5	12	13,8	12,5	12	16,8	12	11,8	10,5
8	6 ÷ 100	14	14	18,5	14,5	14	19	14	15	14
10	6 ÷ 100	18	18	23	18	18	21	18	20	17,5
12	6 ÷ 100	22	22	22	22	18	18	18	18	20

Materials: steel, brass, copper, aluminium and alloys, stainless steel